



Control Stations



October 2010

Control Stations

Product Characteristics

General Characteristics	
Products	Control Stations
Reference Standard	IEC 60947-5-1, EN 60947-5-1, IEC 337-1, UL 508, CSA G-22-2 n° 14
Approval	UL, cUL, CSA, CE
Protection Degree	IP 65 / IP 66 (as per IEC), NEMA 4 / 4X (special version)
Ambient Temperature	-40°C - + 70°C (Storage) -25°C - + 70°C (Operation)
Vibration Resistance	15g (40 Hz < frequency < 500 Hz) conforming to IEC 68-2-6
Shock Resistance	Push Buttons : 70g, Mushroom Head Push Buttons : 15g, Selector Switches : 200g conforming to IEC 68-2-27
Material and Colour	Thermoplastic - grey lid and black base for 1,2,3,4 way, yellow lid & black base for one way Aluminium Die Cast - grey lid and dark grey base
Cable Entry	Knock-outs provided

Control Stations - Metal

Control Stations - Assembled / Empty



RC1M114



RC2M241



RC3M341



RC-2M



RC-1M



RC-4M



RC-3M

Complete Control Stations - Start & Stop Functions Metal, Spring Return

Description	Scheme	Colour	Marking on Legend	Reference
1 Flush Push Button	NO	Green	I START	RC 1M 102 RC 1M 103
1 Flush Push Button	NC	Red	O STOP	RC 1M 112 RC 1M 114
Latching Push Button	NC	Red	STOP	RC 1MBS42
Mushroom Head Key Switch	NC	Red	STOP	RC 1MBS142
2 Flush Push Button	NO+NC	Green	I	RC 2M 213
2 Flush Push Button	NO+NC	Red	O	RC 2M 215
2 Flush Push Button	NO+NC	Green	START	RC 2M 216
2 Flush Push Button	NO+NC	Red	STOP	

Complete Control Stations - Directional/Movement Metal, Spring Return

2 Flush Push Button	NO + NO	White	↕	RC 2M 222
		Black	Up-Down	RC 2M 222A
		White	↔	RC 2M 223
		Black	Right-Left	RC 2M 223A
		White	Open-Close	RC 2M 241
		Black	Forward-Reverse	RC 2M 222B
		Green	Forward	RC 3M 311
			Stop	
Reverse				
3 Flush Push Button	NO + NC + NO	Red	Up	RC 3M 321
			Stop	
			Down	
		Green	Right	RC 3M 331
Stop				
		Black	Left	RC 3M 341
			Open	
		White	Stop	RC 3M 341
			Close	
		Black	↕	RC 3M 324
		Black	↙	RC 3M 334

Empty Control Station Enclosures for customer assembly, Metal

Description	No. of Ways	Colour	Reference
Control Station	1	LID	RC-1M
		BASE	
	2	LID	RC-2M
		BASE	
	3	LID	RC-3M
		BASE	
	4	LID	RC-4M
		BASE	

Control Stations - Metal

Push Button Operating Heads for Control Stations

Metal Operating Heads for use with RC•P & RC•M enclosures - IP65



RM2-BA4



RM2-BL4



RM2-BP4



RM2-BA48



RM2-BS64



RM2-BS14

Description	Knob Size	Colour			
Flush Push Button Spring Return		○ White	RM2-BA1		
		● Black	RM2-BA2		
		● Green	RM2-BA3		
		● Red	RM2-BA4		
		● Yellow	RM2-BA5		
		● Blue	RM2-BA6		
		↓ Black Arrow on White base	RM2-BA334		
		○ White Arrow on Black base	RM2-BA335		
		Recess (Guarded) Push Button		○ White	RM2-BA16
				● Black	RM2-BA26
● Green	RM2-BA36				
● Red	RM2-BA46				
● Yellow	RM2-BA56				
● Blue	RM2-BA66				
Projecting Push Button Spring Return				○ White	RM2-BL1
		● Black	RM2-BL2		
		● Green	RM2-BL3		
		● Red	RM2-BL4		
		● Yellow	RM2-BL5		
		● Blue	RM2-BL6		
		Booted Push Button Spring Return IP65		○ White	RM2-BP1
● Black	RM2-BP2				
● Green	RM2-BP3				
● Red	RM2-BP4				
● Yellow	RM2-BP5				
● Blue	RM2-BP6				
Flush Push Button Spring Return with Transparent Boot IP65		○ White	RM2-BA18		
		● Black	RM2-BA28		
		● Green	RM2-BA38		
		● Red	RM2-BA48		
		● Yellow	RM2-BA58		
		● Blue	RM2-BA68		
		Mushroom Head Push Button Spring Return	∅ 40mm	● Black	RM2-BC2
● Green	RM2-BC3				
● Red	RM2-BC4				
● Yellow	RM2-BC5				
● Blue	RM2-BC6				
Mushroom Head Push Button Turn to Release	∅ 30mm			● Red	RM2-BR4
	∅ 40mm	● Red	RM2-BS44		
	∅ 60mm	● Red	RM2-BS64		
Mushroom Head Push Button Key Release - Key No. 455	∅ 40mm	● Red	RM2-BS14		
Mushroom Head Push Button Push to Stay and Pull to Release	∅ 40mm	● Red (Pre Marked)	RM2-BT4		
		● Red	RM2-BT43		

Control Stations - Metal

Push Button Operating Heads for Control Stations



RM2-BD2



RM2-BJ2



RM2-BG2



RB2-BE102-BM

Metal Selector Heads for use with RC•P & RC•M enclosures - IP65

Description	Type	Operator	Reference
2 Position	Stay Put	Standard Handle	RM2-BD2
		Long Handle	RM2-BJ2
	Spring Return	Standard Handle	RM2-BDR2
		Long Handle	RM2-BJR2
3 Position	Stay Put	Standard Handle	RM2-BD3
		Long Handle	RM2-BJ3
	Spring Return	Standard Handle	RM2-BDR3
		Long Handle	RM2-BJR3
	1 Spring Return Right to Centre	Standard Handle	RM2-BD8
	1 Spring Return Left to Centre	Long Handle	RM2-BJ8
	Standard Handle	RM2-BD7	
	Long Handle	RM2-BJ7	

Metal Key Selector Heads for use with RC•P & RC•M enclosures - IP65

Description	Key Removal	Key Removal	Reference
2 Position Key Switch (Key No. 455)	Stay Put	LH Position	RM2-BG2
		RH Position	RM2-BG02
		All Positions	RM2-BG4
	1 Spring Return Right to Left	LH Position	RM2-BG6
3 Position Key Switch	Stay Put	Centre Position	RM2-BG3
		LH and RH Position	RM2-BG5
		All 3 Positions	RM2-BG0
		RH Position	RM2-BG09
	LH Position	RM2-BG9	
	Both Side Spring Return to Centre	Centre Position	RM2-BG7
Stay Put to Left Spring Return From Right to Centre	Centre Position	RM2-BG8	

Contact Blocks Base Mounted for use with RC•M enclosures - IP65

Description	Contact	Type	Reference
Contact Blocks	NO	STANDARD	RB2-BE101-BM
	NC	STANDARD	RB2-BE102-BM
	NO	GOLD FLASH	RB2-BE1016-BM
	NC	GOLD FLASH	RB2-BE1016-BM

Control Stations - Plastic

Control Stations - Assembled / Empty



RC 1P114



RC 2P241



RC 3P341



RC-2P



RC-1P



RC-4P



RC-3P



RC-1PY

Complete Control Stations - Start & Stop Functions Plastic, Spring Return

Description	Schema	Colour	Marking on Legend	Reference
1 Flush Push Button	NO	Green	I START	RC 1P 102 RC 1P 103
1 Flush Push Button	NC	Red	O STOP	RC 1P 112 RC 1P 114
Latching Push Button	NC	Red	STOP	RC 1PBS42 RC 1PYBS42
Mushroom Head Key Switch	NC	Red	STOP	RC 1PBS142 RC 1PYBS142
2 Flush Push Button	NO+NC	Green Red	I O	RC 2P 213
2 Flush Push Button	NO+NC	Green Red	START STOP	RC 2P 215

Complete Control Stations - Directional/Movement Plastic, Spring Return

2 Flush Push Button	NO + NO	White Black	↕ Up-Down	RC 2P 222 RC 2P 222A
		White Black	↔ Right-Left	RC 2P 223 RC 2P 223A
		White Black	↔ Open-Close	RC 2P 241
		White Black	↔ Forward-Reverse	RC 2P 222B
3 Flush Push Button	NO + NC + NO	Green Red Green	Forward Stop Reverse	RC 3P 311
			Up Stop Down	RC 3P 321
			Right Stop Left	RC 3P 331
			Open Stop Close	RC 3P 341
		White Red Black	↕ ↕ ↕	RC 3P 324 RC 3P 334

Empty Control Station Enclosures for customer assembly, plastic

Description	No. of Ways	Colour	Reference
Control Station Plastic Enclosure	1	LID ☉	RC-1P
		BASE ■	
	2	LID ☉	RC-2P
		BASE ■	
	3	LID ☉	RC-3P
		BASE ■	
	4	LID ☉	RC-4P
		BASE ■	
	1	LID ☉	RC-1PY
			BASE ■

Control Stations - Plastic

Push Button Operating Heads for Control Stations & Dimensions



RP2-BA3



RP2-BL6



RP2-BA48



RP2-BC2



RP2-BA25



RP2-BD2

Plastic Operating Heads for use with RC•P & RC•M enclosures - IP65

Description	Knob Size	Colour	
Flush Push Button Spring Return		○ White	RP2-BA1
		● Black	RP2-BA2
		● Green	RP2-BA3
		● Red	RP2-BA4
		● Yellow	RP2-BA5
		● Blue	RP2-BA6
		↓ Black arrow on White case	RP2-BA334
Projecting Push Button Spring Return		○ White	RP2-BL1
		● Black	RP2-BL2
		● Green	RP2-BL3
		● Red	RP2-BL4
		● Yellow	RP2-BL5
		● Blue	RP2-BL6
		Flush Push Button Spring Return with Transparent Boot IP65	
● Black	RP2-BA28		
● Green	RP2-BA38		
● Red	RP2-BA48		
● Yellow	RP2-BA58		
● Blue	RP2-BA68		
Mushroom Head Push Button Spring Return	∅40mm ∅60mm		
		● Green	RP2-BC3
		● Red	RP2-BC4
		● Yellow	RP2-BC5
		● Blue	RP2-BC6
		● Red	RP2-BR4
Mushroom Head Push Button Turn to Release	∅30mm	● Red	RP2-BS44
	∅40mm	● Red	RP2-BS64
	∅60mm	● Red	RP2-BS64
Mushroom Head Pushbutton Key Release - Key No. 455	∅40mm	● Red	RP2-BS14
Recess (Guarded) Push Button		○ White	RP2-BA16
		● Black	RP2-BA26
		● Green	RP2-BA36
		● Red	RP2-BA46
		● Yellow	RP2-BA56
		● Blue	RP2-BA66

Plastic Operating Heads for Selector Switches for use with RC•P & RC•M enclosures - IP65

Description	Type	Operator	Reference
2 Position	Stay Put	Standard Handle	RP2-BD2
		Long Handle	RP2-BJ2
3 Position	Stay Put	Standard Handle	RP2-BD3
		Long Handle	RP2-BJ3
	Spring Return	Standard Handle	RP2-BDR3
		Long Handle	RP2-BJR3
	1 Spring Return Right to Centre	Standard Handle	RP2-BD8
		Long Handle	RP2-BJ8
	1 Spring Return Left to Centre	Standard Handle	RP2-BD7
		Long Handle	RP2-BJ7

Control Stations - Plastic

Push Button Operating Heads for Control Stations & Dimensions



RP2-BG2

Plastic Operating Heads for Key Switches - IP 65 for use with RC•P & RC•M enclosures - IP65

Description	Type	Key removal	Reference
2 Position	Stay Put	LH Position	RP2-BG2
		RH Position	RP2-BG02
		All Positions	RP2-BG4
3 Position	Stay Put	Centre Position	RP2-BG3
		LH and RH Position	RP2-BG5
		All 3 Positions	RP2-BG0
		RH Position	RP2-BG09
	LH Position	RP2-BG07	
	Both Side Spring Return To Centre	Centre Position	RP2-BG7
	Stay Put To Left Spring Return From Right To Centre	Centre Position	RP2-BG8



RB2-BE101-BP

Contact Blocks for RC•P enclosures - IP65

Description	Contact	Type	Reference
	NO	STANDARD	RB2-BE101-BP
	NC	STANDARD	RB2-BE102-BP
	NO	GOLD FLASH	RB2-BE1016-BP
	NC	GOLD FLASH	RB2-BE1026-BP

Dimensions

	Plastic				Metal			
	1 Hole (inch/mm)	2 Hole (inch/mm)	3 Hole (inch/mm)	4 Hole (inch/mm)	1 Hole (inch/mm)	2 Hole (inch/mm)	3 Hole (inch/mm)	4 Hole (inch/mm)
H	2.1" / 51	2.1" / 51	2.1" / 51	2.1" / 51	2.1" / 51	2.1" / 51	2.1" / 51	2.1" / 51
W	2.68" / 68	2.68" / 68	2.68" / 68	2.68" / 68	2.68" / 68	2.68" / 68	2.68" / 68	2.68" / 68
L	2.91" / 74	4.09" / 104	5.28" / 134	6.46" / 164	2.91" / 74	4.13" / 105	5.28" / 134	6.46" / 164
W1	2.13" / 54	2.13" / 54	2.13" / 54	2.13" / 54	2.13" / 54	2.13" / 54	2.13" / 54	2.13" / 54
L1	1.5" / 38	2.68" / 68	2.68" / 68	5.04" / 128	1.31" / 46	3.07" / 78	4.25" / 108	5.43" / 138

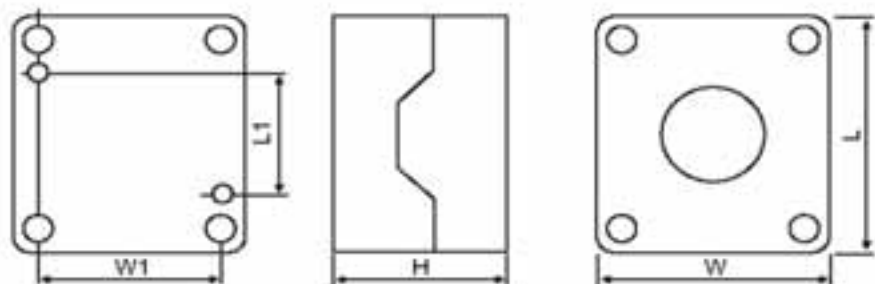

Control Stations - Plastic

Push Button Operating Heads for Control Stations & Dimensions









RB2-BY2321-PSQ



RB2-BY7776-PSQ

Legends

Text	Code	Text	Code
BLANK	RB2-BY2301-PSQ	OPEN	RB2-BY2313-PSQ
START	RB2-BY2303-PSQ	CLOSE	RB2-BY2314-PSQ
STOP	RB2-BY2304-PSQ	AUTO	RB2-BY2315-PSQ
FORWARD	RB2-BY2305-PSQ	HAND	RB2-BY2316-PSQ
REVERSE	RB2-BY2306-PSQ	INCH	RB2-BY2321-PSQ
UP	RB2-BY2307-PSQ	RESET	RB2-BY2323-PSQ
DOWN	RB2-BY2308-PSQ	SLOW	RB2-BY2327-PSQ
RIGHT	RB2-BY2309-PSQ	FAST	RB2-BY2328-PSQ
LEFT	RB2-BY2310-PSQ	LOW	RB2-BY2333-PSQ
ON	RB2-BY2311-PSQ	HIGH	RB2-BY2334-PSQ
OFF	RB2-BY2312-PSQ	RIGHT	RB2-BY2398-PSQ
ON 	RB2-BY7771-PSQ	LEFT	RB2-BY2399-PSQ
OFF 	RB2-BY7772-PSQ	UP-OFF-DOWN 	RB2-BY7775-PSQ
UP-DOWN 	RB2-BY7773-PSQ	LEFT-OFF-RIGHT 	RB2-BY7776-PSQ
LEFT-RIGHT 	RB2-BY7774-PSQ	ARROW 	RB2-BY7777-PSQ

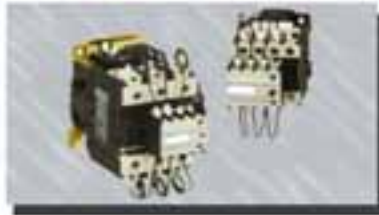

Local Distributor



SHAMROCK CONTROLS

13735 Beta Road • Dallas, Texas • 75244
Ph: (972) 233-6712 • Fax: (972) 233-8039
www.shamrockcontrols.com