



Push Buttons and Pilot Lights - Metal Series



September 2010

Control & Signalling Units - 22.5mm Metal

Characteristics

General Characteristics

Products	Push Buttons, Selector Switches, Key Selector Switches, Latching Mushroom Head Push Buttons, Pilot Lights & Illuminated Push Buttons
Reference Standard	IEC 60947-5-1, EN 60947-5-1, IEC 337-1, UL 508, CSA C-22-2 n° 14
Approval	UL, cUL, CSA, CE
Protection Degree	IP 65 / IP 66 according to IEC 60947-1,
Pollution Degree	3
Temperature	-40°C - + 70°C (Storage) -25°C - + 70°C (Working)
Vibration Resistance	+ 60mm Mushroom Head Push Buttons: 8g, Other Push Buttons & Pilot Lights: 15g (40Hz-frequency-500 Hz) conforming to IEC 68-2-6
Shock Resistance	Push Buttons : 70g, Mushroom Head Push Buttons: 15g, Selector Switches : 200g conforming to IEC 68-2-27
Working Position	All working positions are allowed
Mechanical Life Push Buttons	Push Buttons & Selector Switches 1 million operations, Latching Emergency Mushroom Push Buttons 300,000 operations

Contact Elements Characteristics

Rated Thermal Current I_{th}	10A
Rated Insulation Voltage U_i	500V conforming to IEC 60947-1, UL 508 & CSA 22-2 n° 14
Insulation Category	Group C conforming to NF C 20-040, VDE 0110
Operating Force	Push Buttons - 1 'NO' = 10N, 1 'NC' = 8N Additional contacts - 'NO' = +5N, 'NC' = +3N
Dielectric Strength	2.5KV for 1 minute
Insulation Resistance	2M Ohm min (500 VDC)
Initial Contact Resistance	≤ 25 milli Ohm
Short Circuits Protection	10A 500V, Cartridge Fuse g1 or N conforming to IEC 337-1
Cabling/Terminal Capacity	1x0.5mm ²2x1.5mm ²
Contact Operation	Slow action, Positive Opening
Rated Power	Conforming to IEC 60947-5-1; utilization categories AC 15 & DC 13

DC Supply

Power broken in W
For 1 million operations

Voltage	24V	48V	120V
Inductive Load	65W	48W	40W

Standard Contact Blocks

AC Supply (50/60Hz)
70% Inductive

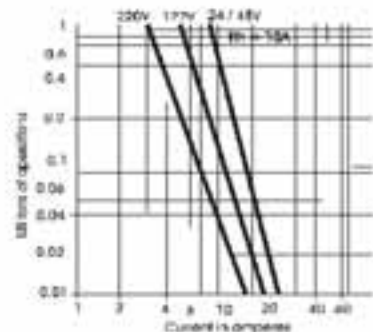

AC Ratings, Inductive - NEMA A500

35% Power Factor

Volts	Make Amperes	VA	Break Amperes	VA	Continuous carrying Amperes	Resistive 75% Power factor Make, Break & continuous Amperes
50	60	7200	8	300	0	0
30	30	7200	3	300	0	0
48	6	7200	15	300	0	0
600	0	7200	12	300	0	0

DC Ratings, NEMA Type Q600

Inductive and resistive

Volts	Make & Break (Amp.)	Continuous (Amp.)
50	0.55	2.5
30	0.27	2.5
60	0.30	2.5

Control & Signalling Units - 22.5mm Metal

Non-Illuminated Push Buttons (Type RB2-B)

(Control Units with chromium plated metal bezel)

Operating Heads for Push Buttons, Spring Return - IP65



RB2-BA4



RB2-BA16



RB2-BL4



RB2-BP4



RB2-BA48



RB2-BS14



RB2-BT43



RB2-BA334 /

Description	Knob Size	Colour			
Flush Push Button Spring Return		○ White	RB2-BA1		
		● Black	RB2-BA2		
		● Green	RB2-BA3		
		● Red	RB2-BA4		
		● Yellow	RB2-BA5		
		● Blue	RB2-BA6		
		↓ Black Arise on White base	RB2-BA334		
		○ White Arise on Black base	RB2-BA335		
		Recess (Guarded) Push Button		○ White	RB2-BA16
				● Black	RB2-BA26
● Green	RB2-BA36				
● Red	RB2-BA46				
● Yellow	RB2-BA56				
● Blue	RB2-BA66				
Projecting Push Button Spring Return		○ White	RB2-BL1		
		● Black	RB2-BL2		
		● Green	RB2-BL3		
		● Red	RB2-BL4		
		● Yellow	RB2-BL5		
		● Blue	RB2-BL6		
Booted Push Button Spring Return IP65		○ White	RB2-BP1		
		● Black	RB2-BP2		
		● Green	RB2-BP3		
		● Red	RB2-BP4		
		● Yellow	RB2-BP5		
		● Blue	RB2-BP6		
Flush Push Button Spring Return with Transparent Boot IP65		○ White	RB2-BA18		
		● Black	RB2-BA28		
		● Green	RB2-BA38		
		● Red	RB2-BA48		
		● Yellow	RB2-BA58		
		● Blue	RB2-BA68		
		Mushroom Head Push Button Spring Return	- 40mm	● Black	RB2-BC2
				● Green	RB2-BC3
				● Red	RB2-BC4
				● Yellow	RB2-BC5
● Blue	RB2-BC6				
● Red	RB2-BR4				
Mushroom Head Push Button Turn to Release	- 30mm	● Red	RB2-BS44		
	- 40mm	● Red	RB2-BS54		
	- 60mm	● Red	RB2-BS64		
Mushroom Head Push Button Key Release - Key No. 455	- 40mm	● Red	RB2-BS14		
Mushroom Head Push Button Push to Stay and Pull to Release	- 40mm	● Red (Pre Marked)	RB2-BT4		
		● Red	RB2-BT43		

Operating Heads with Black metal bezel

To Order add Suffix '7' to above e.g. RB2-BA334 Becomes RB2-BA3347

- For legend plates refer page F9
- For accessories refer page F8 & F9
- For body / contact assemblies refer page F5
- For complete assemblies refer page F10 & F11

Control & Signalling Units - 22.5mm Metal

Non-Illuminated / Illuminated Double Headed Push Buttons, Selector Switches & Key Switches (Type RB2-B) (Control Units with Chromium plated metal bezel)



RB2-BA97



RB2-BW9



RB2-BL87



RB2-BLW9



RB2-B02



RB2-BJ2



RB2-B02

- For legend plates refer page F9
- For accessories refer page F8 & F9
- For contact assemblies refer page F6
- For complete assemblies refer page F10 & F11

Operating Heads for Double Headed Push Buttons

Description	Marking	Colour	Reference
2 Flush Push Buttons, Spring Return W/O Pilot Light - IP40	I O	Green Red	RB2-BA97
1 Flush Push Button 1 Pilot Light (in Centre) 1 Flush Push Button	I O	Green Amber Red	RB2BW9
Non-Illuminated Double Head Push Button with off Projected	I O	Green Red	RB2-BL87
Illuminated Double Head Push Button with off Projected	I O	Green Amber Red	RB2BLW9

Available with assembly unit & with following options:

Filament Bulb	Clear	
Neon Bulb	Amber	
LED	White	Blue
	Green	Clear
	Red	Yellow
	Amber	

Operating Heads for Selector Switches - IP65

Description	Type	Operator	Reference
2 Position	Stay Put	Standard Handle	RB2-B02
		Long Handle	RB2-BL2
	Spring Return to Centre from Right & Left	Standard Handle	RB2-B0R2
3 Position	Stay Put	Long Handle	RB2-BL2
		Standard Handle	RB2-B03
	Spring Return	Standard Handle	RB2-B0R3
		Long Handle	RB2-BL3
	1 Spring Return Right to Centre	Standard Handle	RB2-B08
		Long Handle	RB2-BL8
		Standard Handle	RB2-B07
1 Spring Return Left to Centre	Long Handle	RB2-BL7	

Operating Heads for Key Switches (Key No. 455) - IP65

Description	Type	Key removal	Reference
2 Position	Stay Put	LH Position	RB2-B02
		RH Position	RB2-B002
		All Positions	RB2-B04
3 Position	1 Spring Return Right to Left	LH Position	RB2-B06
		Centre Position	RB2-B03
	Stay Put	LH and RH Position	RB2-B05
		All 3 Positions	RB2-B00
		RH Position	RB2-B000
	Stay Put to Left Spring Return from Right to Centre	LH Position	RB2-B09
		Centre Position	RB2-B08
Spring Return to Centre from Right and Left		Centre Position	RB2-B07

Operating Heads with Black metal bezel





To Order Add Suffix '7' to above e.g. RB2-B02 Becomes RB2-B027

Control & Signalling Units - 22.5mm Metal

Illuminated Push Buttons & Selector Switches (Type RB2-B)

(Signalling Units with Chromium plated metal bezel)

Operating Heads for Illuminated Push Buttons - IP65

Description	Application	Colour	Reference
 Flush Push Button Spring Return	For Incandescent Bulbs	○ White	RB2-BW31
		● Green	RB2-BW33
		● Red	RB2-BW34
		● Amber	RB2-BW35
		● Blue	RB2-BW36
		○ Clear	RB2-BW37
 Projecting Push Button Spring Return	For Incandescent Bulbs	○ White	RB2-BW11
		● Green	RB2-BW13
		● Red	RB2-BW14
		● Amber	RB2-BW15
		● Blue	RB2-BW16
		○ Clear	RB2-BW17
 Flush Push Button Spring Return	For LED	○ White	RB2-BWL31
		● Green	RB2-BWL33
		● Red	RB2-BWL34
		● Amber	RB2-BWL35
		● Blue	RB2-BWL36
		○ Clear	RB2-BWL37
		● Yellow	RB2-BWL38
 Projecting Push Button Spring Return	For LED	○ White	RB2-BWL11
		● Green	RB2-BWL13
		● Red	RB2-BWL14
		● Amber	RB2-BWL15
		● Blue	RB2-BWL16
		○ Clear	RB2-BWL17
		● Yellow	RB2-BWL18
 Booted Type Flush Push Button Illuminated Type	For Incandescent Bulbs	○ White	RB2-BW51
		● Green	RB2-BW53
		● Red	RB2-BW54
		● Amber	RB2-BW55
		● Blue	RB2-BW56
○ Clear	RB2-BW57		

Operating Heads for Illuminated Selector Switches - IP65

Description	Type	Colour	Reference
2 Position	Stay Put	● Green	RB2-BK123
		● Red	RB2-BK124
		● Amber	RB2-BK125
3 Position	Stay Put	● Green	RB2-BK133
		● Red	RB2-BK134
		● Amber	RB2-BK135

Operating Heads for Illuminated - 40mm Mushroom Head Operator

Description	Type	Colour	Reference
2 Position Momentary		● Red	RB2-BW44
		● Green	RB2-BW43
2 Position Maintained		● Red	RB2-BW54
		● Green	RB2-BW53

Operating Heads with Black metal bezel

TO Order Add Suffix '7' to above e.g. RB2-BW31 Becomes RB2-BW317

- For legend plates refer page F9
- For contact assemblies refer page F6
- For complete assemblies refer page F10&F11

- For accessories refer page F8 & F9



RB2-BW34



RB2-BW14



RB2-BW54



RB2-BK124 /
RB2-BK134



RB2-BW44 /
RB2-BW54

Control & Signalling Units - 22.5mm Metal

Assemblies for Illuminated, Non-Illuminated type Push Buttons & Selector Switches (Type RB2-B)



RB2-BZ101

Body assemblies with fixing collar & contact blocks (screw clamp terminal connections)

Description	Contact	Type	Reference
For Push Buttons, Selector and Key Switches	NO	Standard	RB2-BZ101
	NC	Standard	RB2-BZ102
	NO+NO	Standard	RB2-BZ103
	NC+NC	Standard	RB2-BZ104
	NO+NC	Standard	RB2-BZ105
	NO	Gold Flash	RB2-BZ1016
	NC	Gold Flash	RB2-BZ1026
	NO+NO	Gold Flash	RB2-BZ1036
	NC+NC	Gold Flash	RB2-BZ1046
	NO+NC	Gold Flash	RB2-BZ1056



RB2-BE101

Additional / Replacement Contact Blocks

Description	Contact	Type	Reference
For making up Body Assemblies with 3, 4, 5 or Maximum of 6 Contact Blocks or Replacing 1 st OR 2 nd Contact	NO	Standard	RB2-BE101
	NC	Standard	RB2-BE102
	NO	Gold Flash	RB2-BE1016
	NC	Gold Flash	RB2-BE1026

Body assemblies for illuminated Push Buttons & Selectors with or w/o Contacts

Description	Supply Voltage	Contact	Colour	Reference	
Direct BA9s Filament Bulb* Supplied	12V / 24V / 48V / 110V / 130V (AC)(DC) o	NO + NC		RB2-BW065	
		WO Contact Blocks		RB2-BW066	
Through Resistor BA9s, 130V Filament Bulb Supplied	220V (AC)(DC)	NO + NC		RB2-BW075	
		WO Contact Blocks		RB2-BW077	
Through Resistor & Diode BA9s 130V Bulb Supplied	240V (AC)	NO + NC		RB2-BW075	
		WO Contact Blocks		RB2-BW077	
Direct BA9s Neon Bulb Supplied	220V / 380V / 415V (AC)(DC)	NO + NC	Green	RB2-BWN065	
			Natural	RB2-BWN066	
		WO Contact Blocks	Green	RB2-BWN063	
			Natural	RB2-BWN066	
With Integral Circuit & Cluster LED	12V, 24V, 48V (AC)(DC) 110VAC, 110VDC 240V (AC) 220V (DC)	NO + NC	White	RB2-BWL715	
			Green	RB2-BWL735	
			Red	RB2-BWL745	
			Amber	RB2-BWL755	
			Blue	RB2-BWL765	
			Clear	RB2-BWL775	
			Yellow	RB2-BWL785	
			WO Contact Blocks	White	RB2-BWL71
				Green	RB2-BWL73
				Red	RB2-BWL74
				Amber	RB2-BWL75
				Blue	RB2-BWL76
				Clear	RB2-BWL77
				Yellow	RB2-BWL78



RB2-BW06



RB2-BWL7

- o Body assemblies (available for bulb 2.0W max.) upto 220V max. available without bulb
- * Bulb rating: 12V to 130V, 2.0W (max.)
- For accessories refer page F9 & F9
- Please mention voltage while ordering
- For complete assemblies refer page F10 & F11

Control & Signalling Units - 22.5mm Metal

Pilot Light Heads & Bodies (Type RB2-B)



RB2-BV04



RB2-BV5



RB2-BV6



RB2-BV7

Pilot Light Heads

Description	Colour	Reference
For Incandescent Bulbs	○ White	RB2-BV01
	● Green	RB2-BV03
	● Red	RB2-BV04
	● Amber	RB2-BV05
	● Blue	RB2-BV06
	○ Clear	RB2-BV07
	High Contrast, for use With Neon Bulbs** or LEDs	○ White
● Green		RB2-BVL03
● Red		RB2-BVL04
● Amber		RB2-BVL05
● Blue		RB2-BVL06
○ Clear		RB2-BVL07
● Yellow		RB2-BVL09

Complete Pilot Light Bodies

Description	Supply voltage	Colour	Reference
Direct BA 9s Filament Bulb* Supplied	12V / 24V / 48V / 110V / 230V (AC)(DC)○	-	RB2-BV5
Through Resistor BA 9s, 130V Filament Bulb Supplied	240V (AC)(DC)	-	RB2-BV7
Through Resistor & Diode BA 9s, 130V Filament Bulb Supplied	240V (AC)	-	RB2-BVD7
Via Integral Transformer 1.2VA BA 9s, 6V Filament Bulb Supplied	110V / 6V (AC)	-	RB2-BV3
Direct BA 9s, Neon Bulb Supplied	220V / 380V / 415V (AC)(DC)	● Green	RB2-BVN3
		● Red	RB2-BVN4
		● Amber	RB2-BVN5
Integral Circuit & Cluster LED	12V, 24V, 48V (AC)(DC) 110VAC, 110VDC 220V (DC) 240V (AC)	○ White	RB2-BVL71
		● Green	RB2-BVL73
		● Red	RB2-BVL74
		● Amber	RB2-BVL75
		● Blue	RB2-BVL76
		○ Clear	RB2-BVL77
		● Yellow	RB2-BVL78

- ○ Body assemblies (suitable for bulb 2.6W max.) upto 200V max. available without bulb
- * Bulb rating 12V to 130V, 2.6W (max.)
- ** For Neon bulbs, only Green, Red & Amber is available.
- ■ Please mention voltage while ordering
- For accessories refer page F8 & F9
- For legend plates refer page F9
- For complete assemblies refer page F10 & F11

Control & Signalling Units - 22.5mm Metal

Accessories



RL1-CF*



RL1-CN*



RB2-BV004



RB2-BW004



RC-S



RCB2AL8R



RCB2AL8H

Bulbs

Description	Supply Voltage	Colour	Reference
Incandescent Filament Lamp (Different wattage for various voltages)	6V, 12V, 24V, 48V, 130V	Clear	RL1-CF*
Neon BA 9s	220V, 380V, 415V	Green	RL1-CN*
		Natural	RL1-CN*

Lenses

Description	Colour	Reference
Set of Lens for (One Inner Diffuser & One outer lens) for Pilot Lamp Head	White	RB2-BV001
	Green	RB2-BV003
	Red	RB2-BV004
	Amber	RB2-BV005
	Blue	RB2-BV006
	Clear	RB2-BV007
	Set of Lens for (One Inner Diffuser & One outer lens) for Illuminating Actuator	White
Green		RB2-BW003
Red		RB2-BW004
Amber		RB2-BW005
Blue		RB2-BW006
Clear		RB2-BW007
Lenses for Illuminating LED & Neon* Actuator (Without Inner Diffuser)		White
	Green	RB2-BWL003
	Red	RB2-BWL004
	Amber	RB2-BWL005
	Blue	RB2-BWL006
	Clear	RB2-BWL007
	Yellow	RB2-BWL008

Boots

Description	Colour	Reference
Silicon Rubber Boots (for RB2-BP) Suitable for Oil & Humid Condition	White	RB2-BP001
	Black	RB2-BP002
	Green	RB2-BP003
	Red	RB2-BP004
	Yellow	RB2-BP005
	Blue	RB2-BP006
Boots Suitable for Non-Illuminating Flush Pushbuttons (RB2-BA)	Clear	RC-S
Boots Suitable for Illuminated Flush Pushbuttons (RB2-BW)	Clear	RC-L

Reset Extended Push Button

Description	Reference
Reset Extended Push Button (Round Type)	RCB2AL8R
Reset Extended Push Button (Hex Type)	RCB2AL8H

- * Replace with voltage
- ** For Neon bulbs, only Green, Red & Amber is available.

Control & Signalling Units - 22.5mm Metal

Accessories & Legend Plates



RB2-B



RB2-RPX



RB2-BZ41M



RB2-QC12



RB2 - K455



RB2-BY



RB2-PY9330

Accessories

Description	Reference
Flange Collar	RB2-B
Reset Plunger	RB2-RPX
Bulb Extractor for Ba 9s Bulbs	RB2-X13
Quick Connector for NO / NC Contact	RB2-QC12
Spare / Replacement Keys for Key Operating Units (Key No. 455)	RB2-K455
Padlocking Attachment (Makes Flush Operator Inaccessible)	RB2-BZ6
Panel Adaptor Converts 30mm Hole to 22mm Hole	RB2-BZ41M

Legend Plates

Metal (Aluminium)	Reference
Black Coated Legend Plates with Inscription in White Colour	RB2-BY**
Emergency Stop • 60mm	RB2-AY9330
Emergency Stop • 90mm	RB2-AY8330
Plastic	Reference
Emergency Stop • 60mm	RP2-PY9330
Emergency Stop • 90mm	RP2-PY8330

Legends (Replace ** with...)

Text	Code	Text	Code
Blank	RB2-BY2301	Emergency Stop	RB2-BY2330
Start	RB2-BY2303	Stop	RB2-BY2304
Forward	RB2-BY2305	Reverse	RB2-BY2306
Up	RB2-BY2307	Down	RB2-BY2308
On	RB2-BY2311	Off	RB2-BY2312
Open	RB2-BY2313	Close	RB2-BY2314
Auto	RB2-BY2315	Hand	RB2-BY2316
Reset	RB2-BY2323	Inch	RB2-BY2321
Slow	RB2-BY2327	Fast	RB2-BY2328
Auto - Hand	RB2-BY2364	Auto - O - Hand	RB2-BY2385
Hand Off Auto	RB2-BY2367	Low	RB2-BY2333
High	RB2-BY2334	High Low	RB2-BY2335
Off On	RB2-BY2336	Stop Start	RB2-BY2337
Up Down	RB2-BY2338		

Control & Signalling Units - 22.5mm Metal

Dimensions / Complete Units' Reference

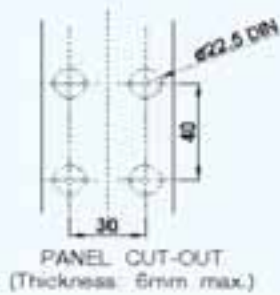

RB2-BE 10 ↔ RB2-B ↔ RCB2-EZ 10 ↔

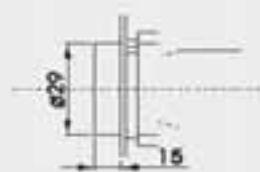
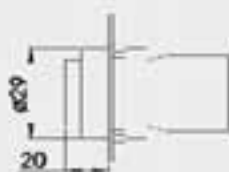

RB2-BA ↔ RB2-EZ 10 ↔ FCB2-BA ↔ RB2-BL ↔ RB2-EZ 10 ↔ FCB2-BL ↔ RB2-BA34 ↔ RB2-EZ 10 ↔ FCB2-BA34 ↔

RB2-BP ↔ RB2-EZ 10 ↔ FCB2-BP ↔ RB2-BA ↔ RB2-EZ 10 ↔ FCB2-BA ↔

RB2-BC ↔ RB2-EZ 10 ↔ FCB2-BC ↔ RB2-B54 ↔ RB2-EZ 10 ↔ FCB2-B54 ↔ RB2-BT4 ↔ RB2-EZ 10 ↔ FCB2-BT4 ↔

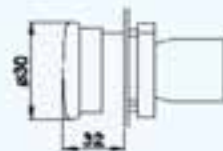

RB2-B544 ↔ RB2-EZ 10 ↔ FCB2-B544 ↔

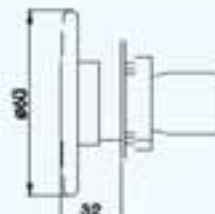

RB2-BF4 ↔ RB2-EZ 10 ↔ FCB2-BF4 ↔ RB2-B554 ↔ RB2-EZ 10 ↔ FCB2-B554 ↔

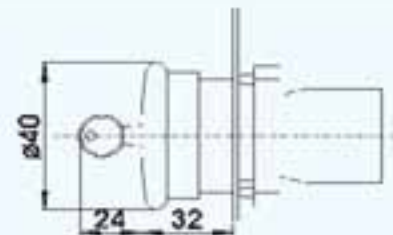

RB2-B5 14 ↔ RB2-EZ 10 ↔ FCB2-B5 14 ↔



RB2-BC2 ↔ RB2-EZ 10 ↔ FCB2-BC2 ↔ RB2-BC3 ↔ RB2-EZ 10 ↔ FCB2-BC3 ↔



RB2-BL2 ↔ RB2-EZ 10 ↔ FCB2-BL2 ↔ RB2-BL3 ↔ RB2-EZ 10 ↔ FCB2-BL3 ↔

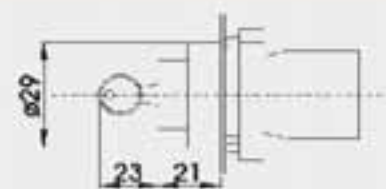

RB2-BG ↔ RB2-EZ 10 ↔ FCB2-BG ↔ (Replace ● with code for position of Key removal & operation pattern)

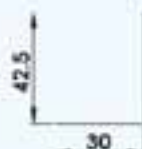
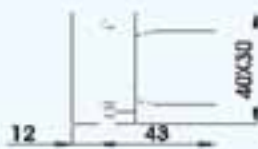

RB2-BA87 ↔ RB2-EZ 10 ↔ FCB2-BA87 ↔

- Replace ◊ with codes for type of contacts (See page F6) & ● with colour codes (See page F3 & F4)
- For non-illuminated push button heads, selector switches & key switches, refer page F3 & F4

Control & Signalling Units - 22.5mm Metal

Dimensions / Complete Units' Reference

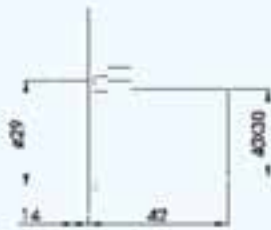

RB2-BV0+RB2-BV6 = FCB2-BV6●
 RB2-BV0+RB2-BV10 = FCB2-BV10●
 RB2-BV0+RB2-BV7 = FCB2-BV7●
 RB2-BV0+RB2-BVDT = FCB2-BVDT●
 RB2-BVLD+RB2-BVLT● = FCB2-BVLT●

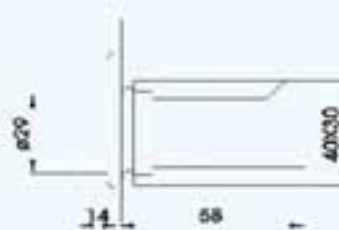

RB2-BV0+RB2-BV0 = FCB2-BV0●
 RB2-BV0+RB2-BV4 = FCB2-BV4●

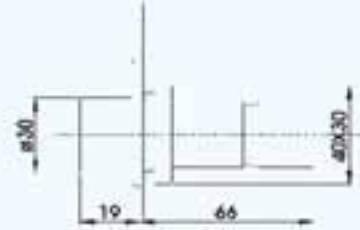

RB2-BW5+RB2-BW06+RB2-BE10 = FCB2-BW5●6+
 RB2-BW5+RB2-BW07+RB2-BE10 = FCB2-BW5●7+
 RB2-BW5+RB2-BW07+RB2-BE10 = FCB2-BW07●7+
 RB2-BW5+RB2-BW06+RB2-BE10 = FCB2-BW5●6+

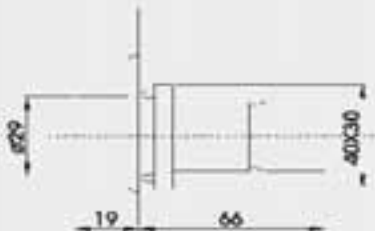

RB2-BW3+RB2-BW06+RB2-BE10 = FCB2-BW3●6+
 RB2-BW3+RB2-BW07+RB2-BE10 = FCB2-BW3●7+
 RB2-BW3+RB2-BW07+RB2-BE10 = FCB2-BW07●7+
 RB2-BW3+RB2-BW06+RB2-BE10 = FCB2-BW3●6+
 RB2-BW3+RB2-BW7+RB2-BE10 = FCB2-BW7●7+
 RB2-BW1+RB2-BW06+RB2-BE10 = FCB2-BW1●6+
 RB2-BW1+RB2-BW07+RB2-BE10 = FCB2-BW1●7+
 RB2-BW1+RB2-BW07+RB2-BE10 = FCB2-BW07●7+
 RB2-BWL1+RB2-BWN06+RB2-BE10 = FCB2-BWL1●6+
 RB2-BWL1+RB2-BWL7+RB2-BE10 = FCB2-BWL1●7+



RB2-BW4+RB2-BW06+RB2-BE10 = FCB2-BW4●6+
 RB2-BW4+RB2-BW07+RB2-BE10 = FCB2-BW4●7+
 RB2-BW4+RB2-BW07+RB2-BE10 = FCB2-BW07●7+
 RB2-BW4+RB2-BWN06+RB2-BE10 = FCB2-BWN4●6+
 RB2-BW4+RB2-BWL7+RB2-BE10 = FCB2-BWL4●7+
 RB2-BW6+RB2-BW06+RB2-BE10 = FCB2-BW6●6+
 RB2-BW6+RB2-BW07+RB2-BE10 = FCB2-BW6●7+
 RB2-BW6+RB2-BW07+RB2-BE10 = FCB2-BW07●7+
 RB2-BW9+RB2-BWN06+RB2-BE10 = FCB2-BW9●6+
 RB2-BW9+RB2-BWL7+RB2-BE10 = FCB2-BWL9●7+

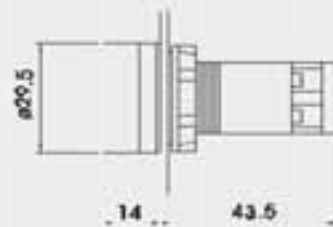

FCB2-ML7●



RB2-BK12+RB2-BW06+RB2-BE10 = FCB2-BK12●6+
 RB2-BK12+RB2-BW07+RB2-BE10 = FCB2-BK12●7+
 RB2-BK12+RB2-BW07+RB2-BE10 = FCB2-BKD12●7+
 RB2-BK13+RB2-BW06+RB2-BE10 = FCB2-BK13●6+
 RB2-BK13+RB2-BW07+RB2-BE10 = FCB2-BK13●7+
 RB2-BK13+RB2-BW07+RB2-BE10 = FCB2-BKD13●7+

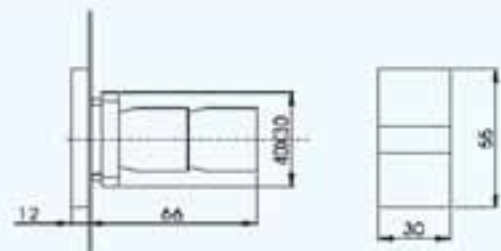

RB2-BW9+RB2-BW06+RB2-BE10 = FCB2-BW96+
 RB2-BW9+RB2-BW07+RB2-BE10 = FCB2-BW97+
 RB2-BW9+RB2-BW07+RB2-BE10 = FCB2-BWD97+
 RB2-BW9+RB2-BWN06+RB2-BE10 = FCB2-BWN065+
 RB2-BW9+RB2-BWL75+RB2-BE10 = FCB2-BWL975+

- Replace '+' with codes for type of contacts (See page F6) & '●' with colour codes (see page F3 & F4)
- For illuminated push button heads, illuminated selector switches, refer page F5
- For pilot lamp head, refer page F7 & for double headed push button with pilot lamp, refer page F4



Local Distributor



SHAMROCK CONTROLS

13735 Beta Road • Dallas, Texas • 75244
Ph: (972) 233-6712 • Fax: (972) 233-8039
www.shamrockcontrols.com